

| | |
|----------------------|---|
| LOA | 12.10 m 39'7" |
| Hull length | 11.99 m 39'4" |
| LWL | 10.80 m 35'5" |
| Beam | 4.04 m 13'3" |
| Draft | 2.05 m 6'8" (standard - iron keel) 1.65 m 5'5" (option - composite iron / lead keel) |
| Displacement | approx. 8.4 t approx. 18,519 lb approx. 7.9 t approx. 17,417 lb |
| Ballast | approx. 2,685 kg approx. 5,919 lb |
| Engine | 27.9 kW / 38 HP |
| Fresh water | approx. 325 l |
| Fuel tank | approx. 140 l |
| CE Certificate | A (ocean) |
| Mast length above WL | approx. 19.52 m approx. 64' |
| Total sail area | approx. 105.60 m ² approx. 1,137 sq ft |
| Main sail | approx. 52.20 m ² approx. 562 sq ft |
| Self-tacking jib | approx. 36.20 m ² approx. 390 sq ft |
| Genoa 140% | approx. 53.40 m ² approx. 575 sq ft (option) |
| Gennaker | approx. 120.00 m ² approx. 1,292 sq ft (option) |
| Rig | I 16.50 m 54'1" J 4.62 m 15'2" P 16.20 m 53'2" E 5.57 m 18'4" |
| Design | judel / vrolijk & co |
| Interior | HanseYachts Design |

Model year 2011/2012 – valid from August 1st, 2011

STANDARD

OPTIONS

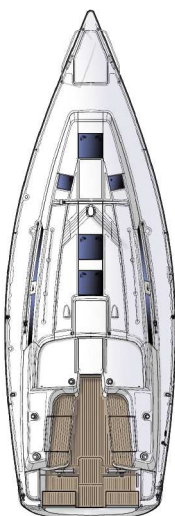

A1

B1

C1

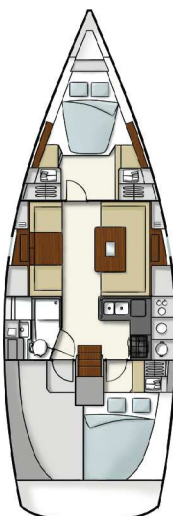

A2

B1

C1

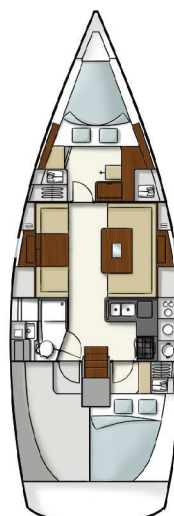

A3

B2

C2

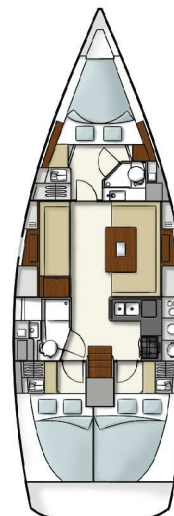

Hull

- White hull
- Dark grey double waterlines
- Options for different hull colour according to Hanse colour selection
- Isophthalic Gelcoat
- Vinylster 1st layer
- Bulk laminate Polyester (orthophthalic or DCPD)
- Sandwich construction (balsa above waterline, foam core below)
- Bulkheads laminated to hull and deck
- GRP strongback

Deck

- White deck
- Isophthalic Gelcoat
- Vinylster 1st layer
- Bulk laminate Polyester (Orthophthalic or DCPD)
- Balsa sandwich
- Non-slip deck surface on coach roof

Steering System

- Rod link steering system
- Twin wheel steering system
- Semi-balanced, profiled rudder with alloy shaft and self-aligning needle bearings
- Emergency tiller

Keel

- T-speed keel with low centre of gravity
- Draft: 2.05 m / 6'8" (iron)
- Option: shallow draft 1.65 m / 5'5" (iron/lead)
- Stainless steel keel bolts

Deck Equipment

- Self-draining anchor locker with lockable hatch
- Self-draining open cockpit with large lockable storage
- 3 opening flush hatches (fwd. cabin)
- 2 opening flush hatches (saloon)
- 3 opening side windows (saloon)
- 1 opening side window (head)
- 2 opening deck hatches on coach roof (aft cabins)
- 1 opening port light at the end of the cockpit bench (aft cabin)
- 4 mooring cleats
- 2 self-tailing halyard winches 40 AST
- 2 self-tailing genoa winches 40 AST
- Halyards lead aft to cockpit
- Control lines covered on the coach roof
- Winch handle
- Shower on aft deck
- Bow fitting with anchor roller - pad eye
- 10 halyard stoppers
- Split pulpit
- Pushpit with ensign staff socket
- Sliding hatch garage
- Sliding hatch
- Wash board
- Double stainless steel wire guard rail
- Handrails
- Teak on cockpit seats
- Swimming ladder

Technical System**Plumbing System / Fresh Water****Tank**

- Fresh water capacity approx. 325 l
- Water inflow on deck

Hot water

- Warm water heater, running from engine or immersion heater 230 V

Pumps

- Electrical pressurised water system

Faucets

- Faucets in galley and head

Draining Pumps**Bilge pumps**

- 1 manual bilge pump
- 1 electric bilge pump

Toilet / Head

- Holding tank
- Sea and deck discharge
- 1 manual marine toilet
- 1 heavy duty shower drain pump

Engine

- Volvo D2-40, 27,9kW / 38 HP, diesel engine
- Saildrive
- Fresh water cooling
- 2-blade fixed propeller
- Fuel tank, approx. 140 l
- Fuel inflow on deck
- Seawater strainer
- Fuel filter / Water separator
- Revolution counter
- Engine hour meter
- Engine room sound insulated

Electrics

- 2 V and 110 V / 230 V electrical circuits
- Shore power 230 V incl. differential breaker

Battery charger

- Battery charger 12 V / 30 Amp.

Batteries

- Main battery switch
- 1 Engine battery: 12 V / 80 Ah AGM
- 1 Service battery: 12 V / 80 Ah AGM

Electric control panel 12 V

- Onboard electrics
 - Socket 12 V
 - Voltmeter
 - Water / Fuel gauges
- Electric panel 230 V**
- Differential breaker
 - Socket 230 V
 - Separate switch for warm water heater

Interior lighting

- in fwd. cabin
- in aft cabin
- in saloon
- in galley
- in head
- in storage room
- in engine room

Navigation lights

- Steaming light
- Bow light
- Stern light
- Anchor light

Navigation instruments

- Illuminated compass
- Depth sounder
- Log

Galley

- Quartz black surface
- Double stainless steel sinks
- 2-burner LPG gas stove with oven, gimballed
- LPG Gas system
- Storage in cockpit
- Lockers and drawers
- Extra large 12 V fridge of approx. 130 l, top and front loader with light
- Waste bin

Interior Accommodation

- High quality marine plywood, mahogany style, satin varnish
- Floorboards: Maple style
- Option: American Cherry or Teak
- White bulkheads
- Wooden door frames
- Wood / Sandwich doors

Upholstery

- According to Hanse colour selection

Forward cabin

- Separated from saloon by a door
- Large "island" berth
- Combined locker
- Shelves above berth
- Options according to Hanse Individual Cabin Concept

Aft cabin

- Separated from saloon by a door
- Large double berth
- Combined locker
- Shelf
- Option: 2nd aft cabin with double berth and locker

Saloon

- Companionway steps
- U-shaped settee area on starboard
- Saloon table
- Bar locker
- Lockers and shelves
- 2 hull windows

Navigation area

- 2 single seats on port side
- Option: long bench
- Chart table with storage between single seats
- Electric switch panel

Head / Shower

- Large head with separate shower stall
- Marine toilet
- Holding tank
- Sea and deck discharge
- Sink
- Electrical drain pump
- Mirror
- Locker & shelves

Rigg and Sails

- 9/10-rig, tapered masttop
- 2 spreader anodised aluminium mast and boom
- Under deck furling system for jib
- Hanse single line reefing system (cockpit handling)
- Rod kicker
- Stainless steel standing rigging
- Backstay adjuster
- Main and jib halyard lead aft to cockpit
- Main and jib sheets
- Midboom sheeting with 2 stand-up blocks
- Main sail fully battened with 2 reefs
- Self-tacking jib with traveller