

SPECIFICATION



technical details

according to ISO 8666

LOA	11.97m TBC	39' 3"
Hull length	11.58 m	38' 0"
Beam	3.87 m	12' 8"
Draft max	1.11 m	3' 8"
Water tank	200 l	44 UK gal
Fuel tank	1.140 l	251 UK gal
Displacement	TBC	TBC
CE Category	B	B
Max. persons	12	12

Engine Standard

2x Volvo Penta D4-320 approx. TBC knots*

Engine Option

2x Volvo Penta D6-440 approx. TBC knots*

*All performance figures are given in good faith and are intended as an indication. Max. speed allowed: 45 knots - Cat D sea state. These figures cannot be guaranteed as top speed in particular is affected by the cleanliness of the hull, conditions of the propellers, weight carried and air/sea temperature. Performance is related also to the optional accessories selected. "TBC" stays for: To Be Confirmed. FJORD reserves the right to change specifications in line with the company policy of improvement through research and development. Standard Propeller tested in Greifswald according to Volvo conditions. All measurements/figures approximate. Errors and omissions excepted. Specification and material can be changed without notice. Please check with your dealer for a full list of inclusions. Valid from 2024.01.01 for deliveries until 2025.06.30. F22A.24.V.2023-12-06.864



EXTERIOR LAYOUTS



*Standard
Decklayout*



Option



*Option
T-Top*

INTERIOR LAYOUTS



A1

Standard

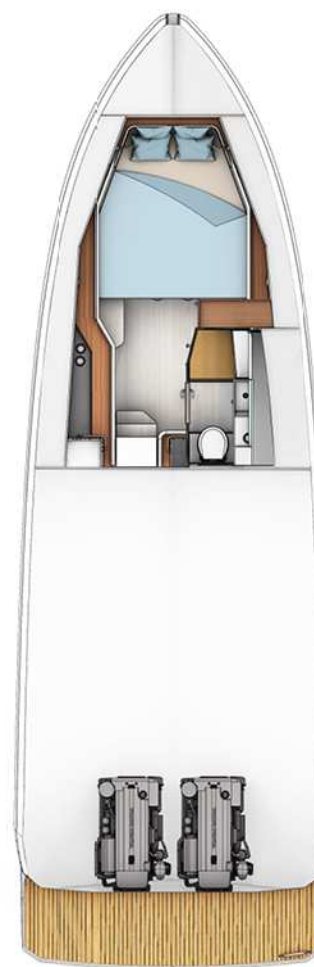

A2

Option

STANDARD EQUIPMENT

HULL

- / GRP hull, isophthalic gelcoat, colour: signal white (according to colour card), 1st layer vinyl ester resin
- / Waterline, isophthalic gelcoat, colour: jet black (according to colour card)

DECK & COCKPIT

- / Dashboard, colour: signal white (according to colour card), with foot support, handrail, switch panel and engine room fire extinguisher system
- / GRP deck, isophthalic gelcoat, colour: signal white (according to colour card), 1st layer vinyl ester resin. Self draining anchor locker. Anchor arm in stainless steel. Stainless steel tie bar for fender. Large diameter stainless steel handrails, gunwale in GRP. Sunpad at bow with upholstery on top.
- / Synthetic teak on deck and bathing platform (according to colour card)
- / FJORD steering wheel with tilting system
- / 4 openable portholes (2 in cabin, 2 in toilet)
- / Windshield in plexiglass, open at the top
- / Bathing platform with telescopic bathing ladder, integrated in bathing platform
- / 1 manual deck hatch in cockpit for access to engine room and 1 to technical compartment
- / 6 aluminium mooring cleats, stainless steel handrails
- / Shower unit with hot and cold water
- / Pilot and 1 copilot seat, fixed

PROPULSION

- / Engine room, sound insulated, fans, fire extinguisher system, automatic and manual, Batteries-Engines: 2 x 90 Ah / 12 V, Battery charger 35 A (for engine and service batteries)
- / 2 Volvo Penta D4 (235 kW/320 hp) stern drive propeller (TBC), joystick, throttles, 2 Volvo 2,5" multifunctional displays

- / Fuel tank, capacity: 1.140 litres, fuel filter

ELECTRICAL EQUIPMENT

- / 12 V and 230 V electric system with 230 V shore power connection. Sockets in cabin (3), toilet (1), engine room (1) and 12V on dashboard (1)
- / Batteries-Service: 1 x 160 Ah AGM
- / Country Version: EU / AUS
- / Wireless charging for mobile phone in cabin (2)
- / Manual toilet
- / Spotlights and indirect lights in cabin and toilet. Light in engine room.
- / Holding tank, capacity: 60 litres
- / Water tank, capacity: 200 litres
- / Hot water boiler and pump
- / Bilge pumps: automatic electric (2) and manual emergency bilge pump in cockpit (1)

LAYOUT & INTERIOR

- / A1: Cabin with double berth, fridge and storage on p side. Fully equipped head with separated shower.

EXTERIOR MODULES

- / D1: Free deck
- / E1: Pilot and copilot seat with galley module sb side, sink with folding mixing tap and storage, working top in marine mineral stone.
- / F1: 2 benches with convertible backrests and upholstery on top
- / G1: Free deck with wired guard rail at stern

UPHOLSTERY & WOOD

- / Covered mattress scheme: porto bello, colour: cream (according to colour card)
- / Exterior upholstery and helmsman seats - Hitch, colour: Starfish (according to colour card)

- / Interior furniture in high quality marine plywood, colour: warm mahogany (according to colour card)
- / Decor elements on p side and next to bedhead - colour: black (according to colour card)
- / Fiddle on p and s side and toilet decorative panel - colour: white (according to colour card)
- / Toilet door, vertical furniture surface on p side and front of the bed incl. 2 drawers in white HPL
- / Ceiling in fiberglass, colour: white
- / Floorboard - pale acacia (according to colour card)

TRANSPORT

- / Identified locations for hand held fire extinguishers - (hand held fire extinguishers are not supplied), FJORD Owner's Manual in FJORD document bag