

# SPECIFICATION

**Dehler**  **46 SQ**



## TECHNICAL DATA

**LOA** 14.94 m / 49' 0"

**HULL LENGTH** 13.95 m / 45' 9"

**LWL** 12.90 m / 42' 4"

**BEAM** 4.35 m / 14' 3"

## DRAUGHT (DWL)

standard 2.25 m / 7' 5"

competition 2.58 m / 8' 6"

L-keel deep 2.48 m / 8' 2"

shallow keel 1.85 m / 7' 1"

## BALLAST

standard 3.50 t / 7,716 lbs

competition 3.15 t / 6,944 lbs

L-keel deep 3.35 t / 7,385 lbs

shallow keel 3.85 t / 8,488 lbs

## DISPLACEMENT

standard 11.50 t / 25,353 lbs

competition 11.20 t / 24,691 lbs

L-keel deep 11.40 t / 25,132 lbs

shallow keel 11.90 t / 26,235 lbs

## ENGINE APPROX.

Diesel 57 PS / hp

## FRESH WATER

approx. 450 l / 119.00 gal

## FUEL TANK

approx. 200 l / 53.00 gal

## MAST ABOVE WL

standard 21.23 m / 69' 8"

competition 22.20 m / 72' 1"

## TOTAL SAIL AREA

standard 116.73 m<sup>2</sup> / 1,256 sq ft

competition 126.79 m<sup>2</sup> / 1,365 sq ft

## MAIN SAIL

standard 64.10 m<sup>2</sup> / 690 sq ft

competition 70.52 m<sup>2</sup> / 759 sq ft

## FURLING JIB 105%

standard 52.63 m<sup>2</sup> / 567 sq ft

competition 56.27 m<sup>2</sup> / 606 sq ft

## SPINNAKER

competition 150.00 m<sup>2</sup> / 1,615 sq ft

## GENNAKER

standard 185.38 m<sup>2</sup> / 1,995 sq ft

competition 214.00 m<sup>2</sup> / 2,303 sq ft

## FREERIDE

standard 120.38 m<sup>2</sup> / 1,296 sq ft

competition 128.50 m<sup>2</sup> / 1,383 sq ft

## RIG

standard I 18.10 m / 59' 5"

J 5.50 m / 18' 1"

P 17.68 m / 58' 0"

E 6.25 m / 20' 6"

competition

I 18.90 m / 62' 0"

J 5.50 m / 18' 1"

P 18.70 m / 61' 4"

E 6.55 m / 21' 6"

## CE CERTIFICATE

Class A

## DESIGN

judel/vrolijk & co.

## INTERIOR

Dehler

All measurements/figures are approximate. Errors and omissions excepted. Specification and material can be changed without notice. Valid from 2023.07.01 for deliveries until 2024.12.31.

# DECK AND INTERIOR LAYOUTS

**Dehler**  **46 SQ**

DECK LAYOUT

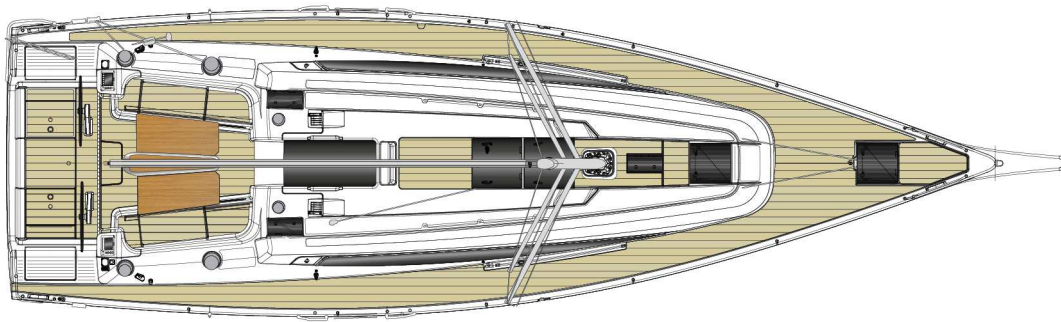

INTERIOR LAYOUT

STANDARD

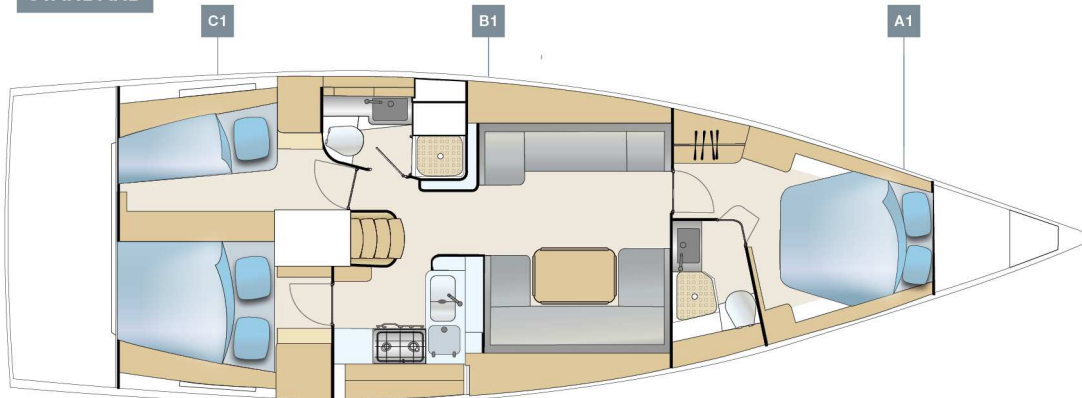

OPTION

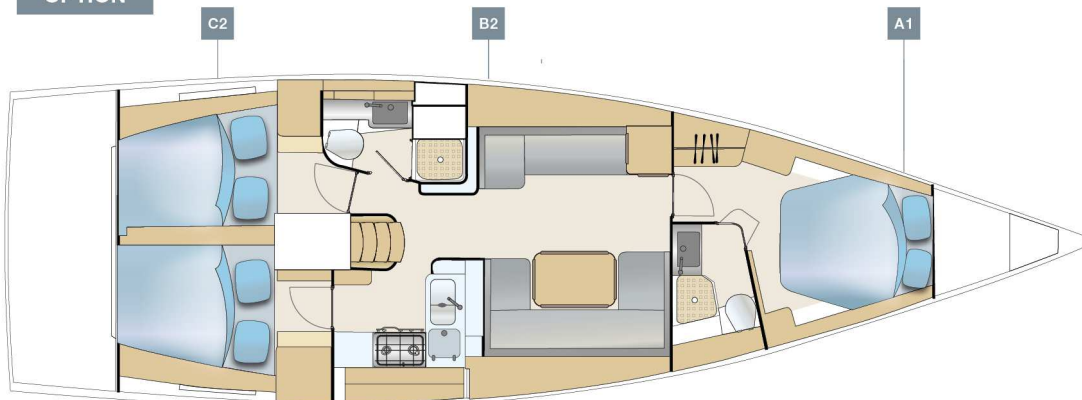

# DECK AND INTERIOR LAYOUTS

**Dehler**  **46 SQ**

INTERIOR LAYOUT

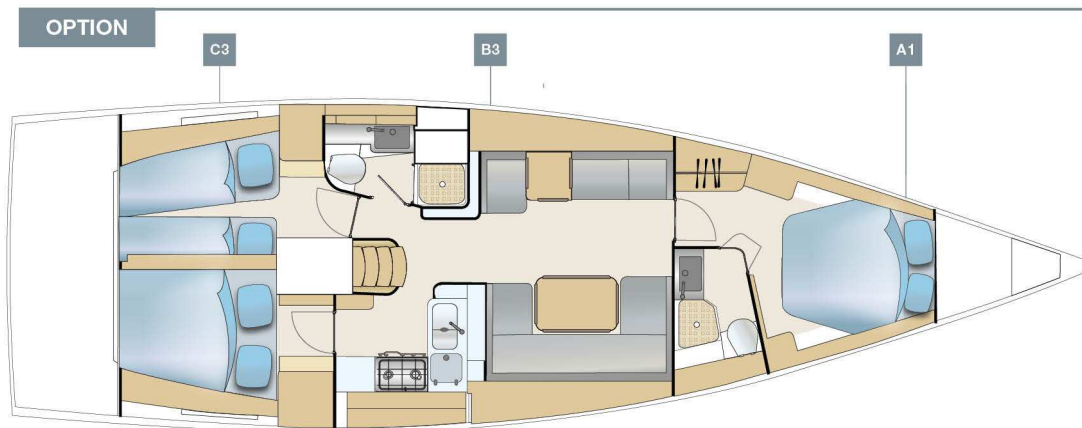

## HULL

- 6 hull windows (3 each side)
- GRP hull, isophthalic gelcoat, colour: Signal White (similar RAL 9003), 1st layer vinylester resin with PVC foam core built in vacuum infusion
- Waterline and cove line, isophthalic gelcoat, colour: Dark Blue (similar RAL 5004)

## KEEL

- L-keel, cast iron, draft: 2.25 m
- GRP rudder with sea-water resistant aluminium shaft and selfaligning bearings

## LAYOUT & INTERIOR

- A1: Master cabin with island double berth, storage space and a head with separate shower stall
- B1: Saloon with L-galley, dining area on stb, long sofa and head with separate shower stall on port
- C1: 2 aft cabins: single berth with locker and storage on port and double berth with locker and storage on stb
- 3-burner gas stove, waste bin, 12 V fridge approx. 130 l, double stainless steel sink with mixing tab
- Interior furniture in high quality marine plywood, satin varnish
- Dehler companionway closing system
- Saloon table, folding with stowage
- Worktop in galley, Off White
- Indirect lights in saloon
- SLS - Scenario light system - touch screen controller and dimmer in saloon and master cabin

## WOOD (FURNITURE, FLOORBOARD)

- Furniture - Mahogany
- Floorboard - Australian Acacia

## UPHOLSTERY

- Mattresses for all berths
- Upholstery - Baltic, colour: creme
- Upholstery - Piping (colour selection)

## DECK & OUTSIDE EQUIPMENT

- GRP deck with antislip surface, isophthalic gelcoat, colour: Signal White (similar RAL 9003), 1st layer vinyl ester resin with balsa sandwich core. Cockpit lockers, stern lockers on port and stb, anchor locker at bow.
- Cockpit bottom, gelcoat colour: Signal White (similar RAL 9003)
- Synthetic teak on coach roof (colour selection)
- Synthetic teak on cockpit benches (colour selection)
- Twin wheel steering system with emergency tiller
- 2 stainless steel steering wheels with leather cover
- Pulpit and pushpit, stainless steel
- Railing, incl. stanchions and stainless steel wire
- Halyards and control lines with organizers and jammers on coach roof, 4 retractable mooring cleats, handrails on coach roof
- 2 LEWMAR 50 Race manual halyard winches
- 2 LEWMAR 50 Race manual secondary winches

- 2 LEWMAR 50 Race manual mainsheet winches
- Swimming ladder
- Rub rail, aluminium
- LED backlight design part on the coach roof
- Helmsman footrests, foldable
- Anchor windlass, electrical with automatic fuse
- Composite bowsprit with integrated anchor fitting
- Genoa tracks, incl. cars, adjustable from cockpit
- German mainsheet system with adjustable traveller
- 6 deck hatches - openable, anchor locker hatch
- 8 deck coach roof windows - openable, portlights in cockpit sides for aft cabins

## RIG & SAILS

- Rig, anodized aluminium, keel stepped incl.: dyform rigging, running rigging, kicker, manual jib flat deck furler, "Dehler Quick Reefing System", hydraulic backstay tensioner
- QUANTUM AC5 performance sails - full battened, triradial, main and jib
- Dyneema halyards for main and jib

## NAVIGATION & INSTRUMENTS

- 2 illuminated compasses at steering pedestal
- Navigation lights - LED

## PROPULSION

- Fuel tank, approx. 200 l
- Engine (Diesel, approx. 57 hp) - saildrive, 3 blade folding propeller

## EQUIPMENT

- 12 V and 230 V electric system with main panel, 12 V and 230 V socket and 230 V shore power
- AGM battery set - capacity: Starter battery: 1 x 90 Ah, service battery: 1 x 160 Ah
- Country Version: EU / AUS
- Battery charger 35 A
- Manual toilet with sea water flush - cabin layout B
- Manual toilet with sea water flush - cabin layout A
- Shower unit in cockpit, warm-/coldwater
- LPG gas system, stowage for 1 bottle
- Manual and electric bilge pump
- Black water system (appr. 85 l) with deck extraction and seacock for aft head, appr. 35 l in fwd head
- Fresh water system with electric pump and 20 l hotwater, heated also by main engine
- Fresh water tank, appr. 450 l

## SHIPPING & TRANSPORT

- CE - Certificate cat. A
- Owners manual
- EC - Type Examination Certificate